

Owned by:



Benaroya Sumner Storage Yard

3101 W Valley Hwy E, Sumner, WA

- 11.97 acres
- Up to 352 trailer stalls
- Fenced, paved and lit
- Secured entrance
- 24 miles to Port of Seattle / 8 miles to Port of Tacoma
- Close proximity to SR 167 & I-5
- Sale price: Call for info
- Lease rate: \$0.12 PSF, NNN

For more information, contact:

Arie Salomon, SIOR, CCIM

+1 425 586 5636
asalomon@nai-psp.com

Jeff Forsberg, CCIM

+1 425 586 5610
jforsberg@nai-psp.com

Taylor Hoff

+1 425 586 5634
thoff@nai-psp.com



600 108th Avenue NE Suite 340
Bellevue, Washington 98004
+1 425 586 5600
nai-psp.com

For Sale or Lease: 11.97 Acres
Benaroya Sumner Storage Yard
3101 W Valley Hwy E, Sumner

11.97 ACRES

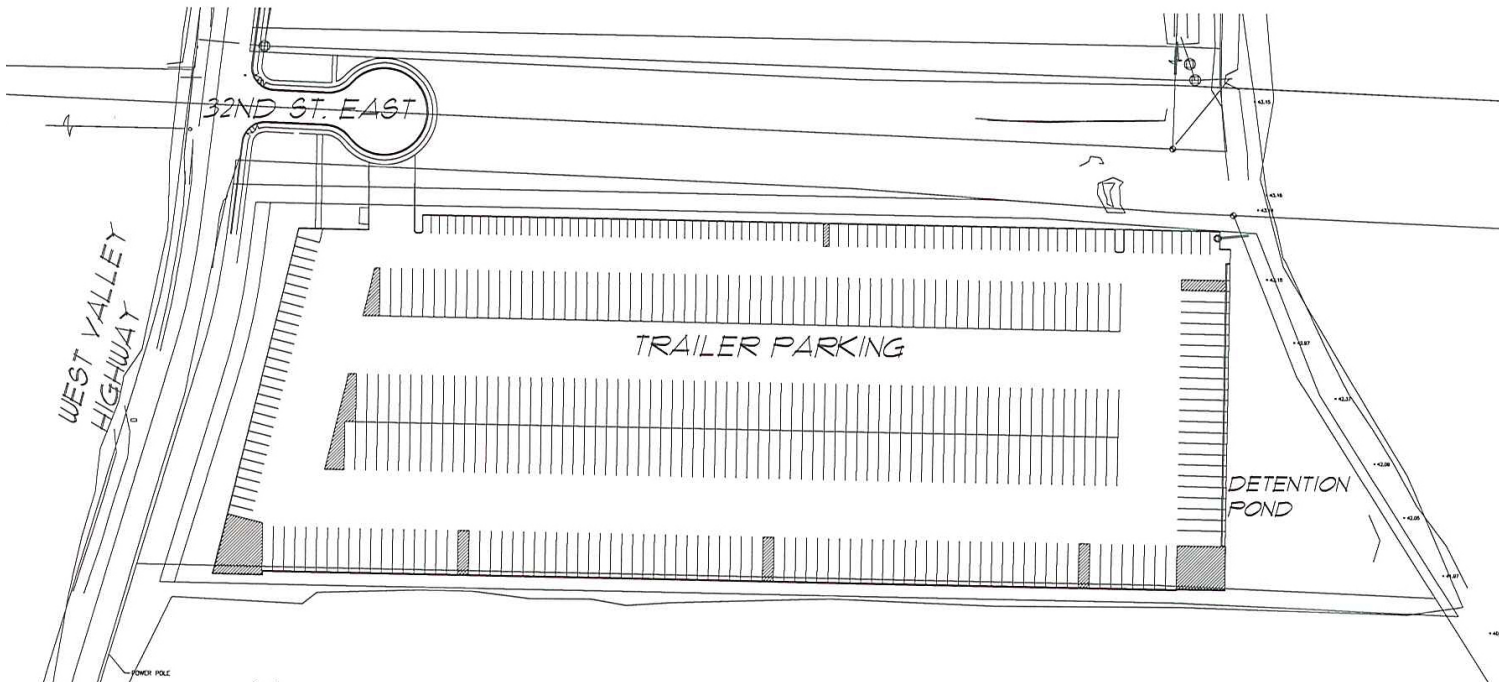

Owned by:



600 108th Avenue NE Suite 340
Bellevue, Washington 98004
+1 425 586 5600
nai-psp.com