

The Benaroya Company

South Hill Business + Technology Center

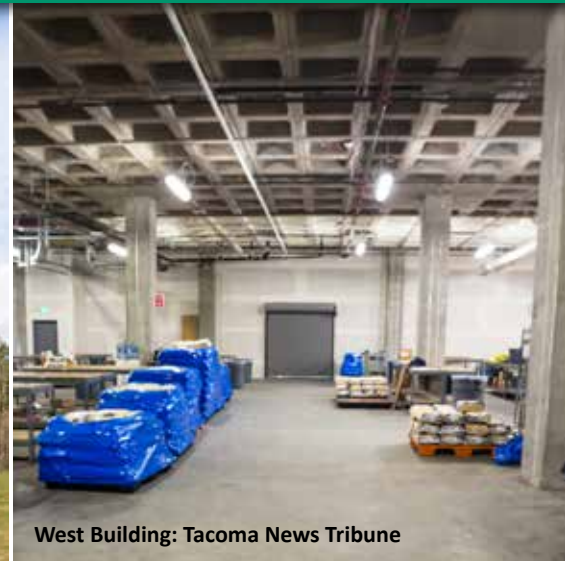

1021 Building: 8,354 sf



West Building: Tacoma News Tribune

AVAILABLE - WAREHOUSE SPACE

Convenient Puyallup South Hill location, hard to find warehouse storage space immediately available. Situated on secured 86 acres, the park-like South Hill Business & Technology Center campus includes abundant parking and easy freeway access.



CONTACT:

David Vranizan
T 425.440.6711
davev@benaroya.com

CBRE

John Bauder
T 253.596.0047
john.bauder@cbre.com

Andrea Peterson
T 253.596.0029
andrea.peterson@cbre.com

LOCATION:

Greater Seattle Area

FEATURES:

- Ample free on-site parking
- Office space available
- Secure campus
- Easy freeway access
- Fully sprinklered
- Zoning: MP Business Park

WEST BUILDING:

1019 39th Ave. SE Puyallup, WA

- 14,750 sf available now
- Shell: \$.32 - .45 psf
Office: \$.85 psf
NNN: \$.1625 psf
- 12' - 13' clear height
- Dock high

1021 BUILDING:

1021 39th Ave. SE Puyallup, WA

- 8,354 sf available March 2017
- Shell: \$.45 psf
Office: \$.85 psf
NNN: \$.12 psf
- 22' clear height
- At grade

The Benaroya Company

South Hill Business & Technology Center



1021 Building



Tacoma News Tribune
Office Build Out

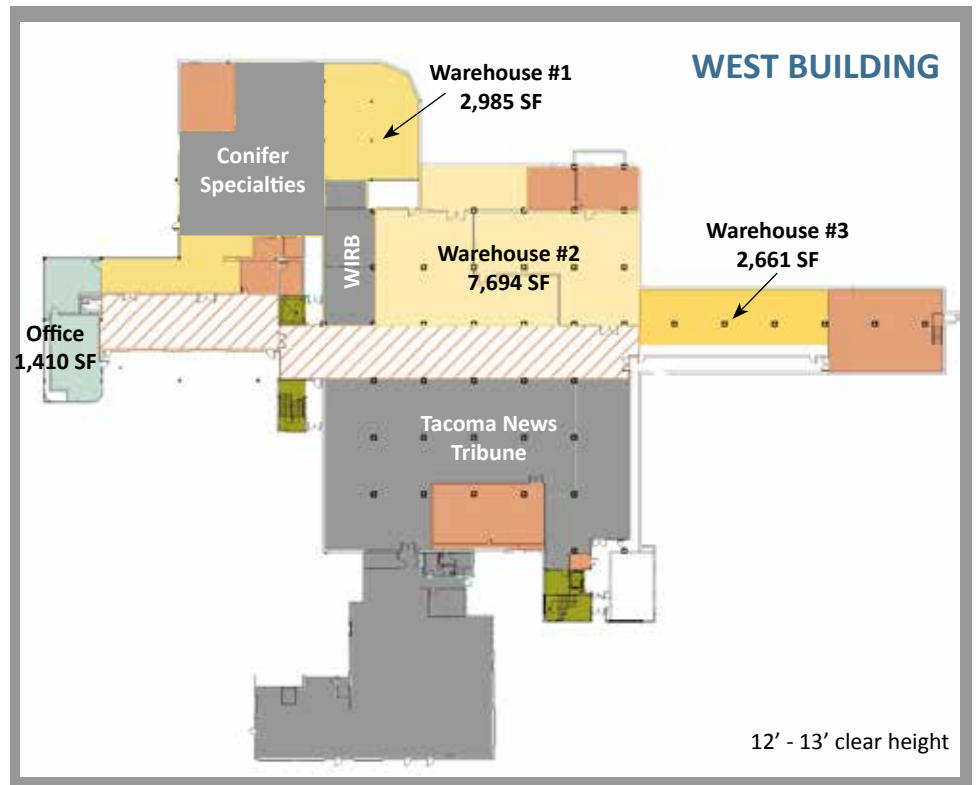

1021 BUILDING

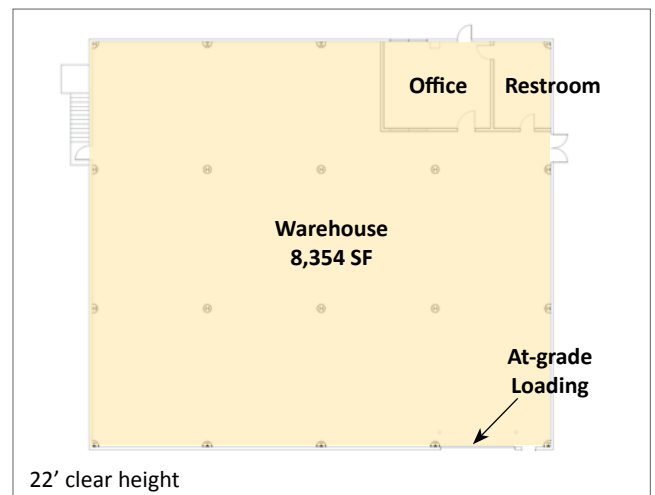

CAMPUS SITE PLAN

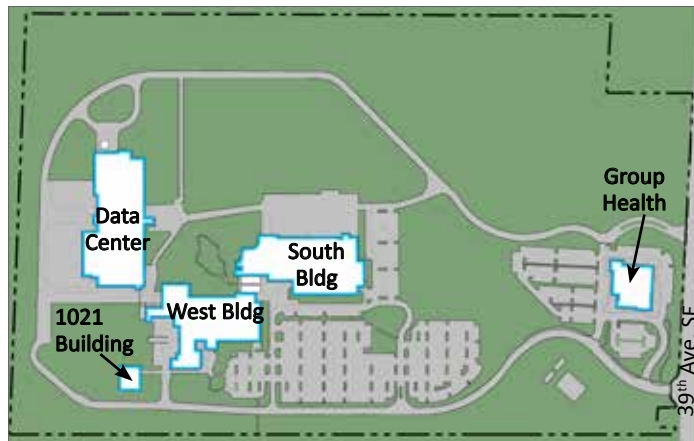

CONTACT:

David Vranizan
T 425.440.6711
davev@benaroya.com

CBRE

John Bauder
T 253.596.0047
john.bauder@cbre.com

Andrea Peterson
T 253.596.0029
andrea.peterson@cbre.com