

The Benaroya Company

Everett Park Place Professional Center - Building E



AVAILABLE FOR LEASE

Building E is one of seven buildings in the Park Place Professional Center in Everett, Washington, with close proximity to Everett Mall's retail amenities and easy freeway access. It features a campus setting with a shared courtyard and greenery.

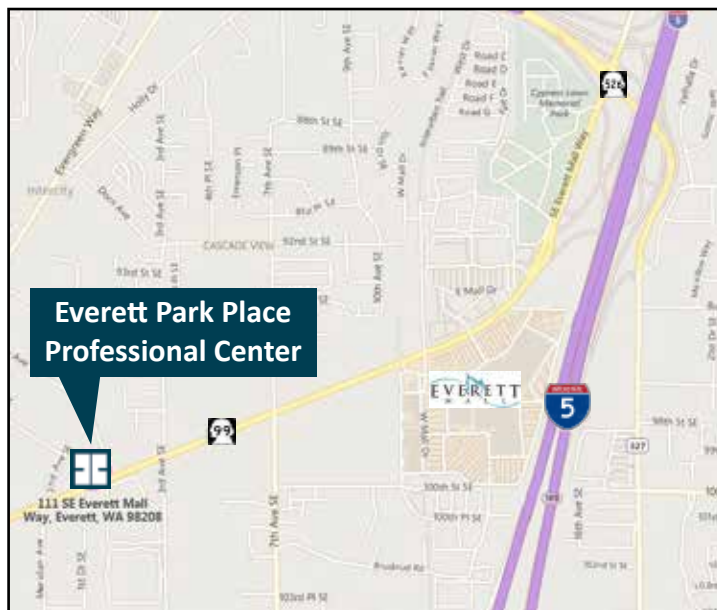

LOCATION:

111 SE Everett Mall Way | Everett, WA 98208

PROPERTY FEATURES:

- Convenient, high traffic & visibility location
- Building demises easily for smaller users
- Available for lease: 806 SF - 1,940 SF
- Lease Rate: \$14.00 NNN
- Parking: 3.5 stalls per 1,000 square feet
- Newly renovated interiors, roof and HVAC
- Signage available on Everett Mall Way
- Attractive seller financing available

CONTACT:

Derek Heed
Colliers International
T 425.453.3133
derek.heed@colliers.com



Larry Benaroya
T 425.440.6700
F 425.440.6730
larryb@benaroya.com

The Benaroya Company

Everett Park Place Professional Center



CONTACT:

Derek Heed
Colliers International
T 425.453.3133
derek.heed@colliers.com



Larry Benaroya
T 425.440.6700
F 425.440.6730
larryb@benaroya.com

3600 136th Pl. SE, Suite 250, Bellevue, WA 98006
T 425.440.6700 F 425.440.6730 www.benaroya.com



The Benaroya Company

Everett Park Place Professional Center - Building E

BUILDING E | FOR LEASE

Rate: \$14.00 NNN

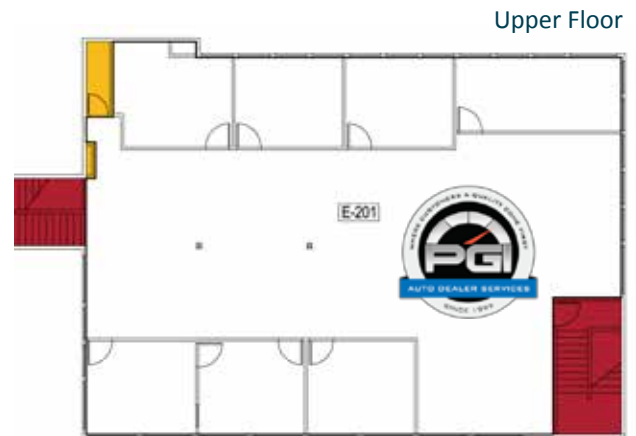
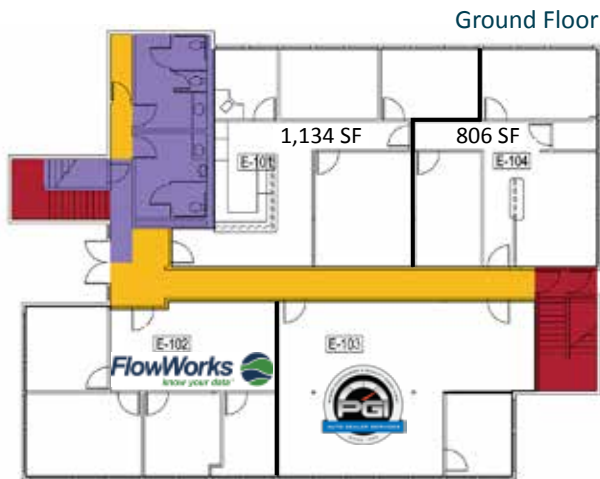

EVERETT PARK PLACE PROFESSIONAL CENTER CAMPUS

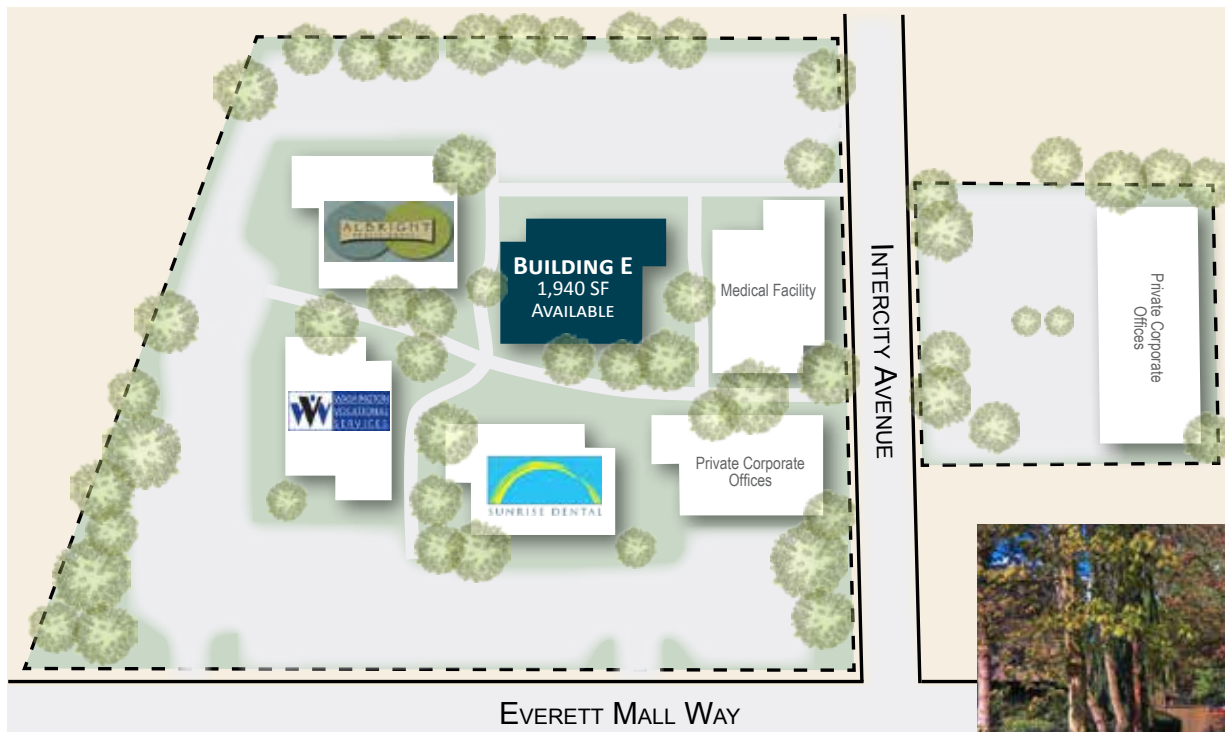

CONTACT:

Derek Heed
Colliers International
T 425.453.3133
derek.heed@colliers.com



Larry Benaroya
T 425.440.6700
F 425.440.6730
larryb@benaroya.com

3600 136th Pl. SE, Suite 250, Bellevue, WA 98006
T 425.440.6700 F 425.440.6730 www.benaroya.com



The Benaroya Company

Everett Park Place Professional Center - Area Amenities



LEGEND ON NEXT PAGE

CONTACT:

Derek Heed
 Colliers International
 T 425.453.3133
 derek.heed@colliers.com



Larry Benaroya
 T 425.440.6700
 F 425.440.6730
 larryb@benaroya.com

The Benaroya Company

Everett Park Place Professional Center - Area Amenities

MAP ON PREVIOUS PAGE

FOOD & DRINK

1. Ade's Mexican Deli
2. Applebees
3. Arby's
4. Azteca Mexican Restaurant
5. A & W
6. Baja Fresh
7. Baskin Robbins
8. Bob's Burgers & Brew
9. Burger King
10. Burgermaster
11. Buzz Inn Steak House
12. CC Teriyaki
13. Chamaole'Pino
14. Dennys
15. DR Espresso
16. Espresso Café
17. Everett Big Foot Java
18. Famous Dave's
19. Foxy's Pub and Eatery
20. Giorgio's Pizza & Spaghetti House
21. Gyro House Café
22. Gyros 2 Go
23. Happy Buffet
24. Hawaiian Sun BBQ
25. Hong Kong
26. International House of Pancakes
27. Janbo Chinese Restaurant
28. Jimmy John's
29. Kyoto Japanese Steakhouse
30. La Hacienda
31. Lanna Thai Restaurant
32. Lazy Boy Brewing Co.
33. Los Postrillos
34. Lucky Buffet
35. Michael's Espresso
36. New York Deli & Burger
37. Olive Garden
38. Orange Julius
39. Outback Steakhouse
40. Panda Express
41. Panera Bread
42. Philly Cheese Steak and Sub
43. Pho Asia Noodle House
44. Pho Than Brothers
45. Pho Hung Traditional Vietnamese
46. Players Sports Bar & Grill
47. Pretzel Twister
48. Quiznos
49. Red Robin
50. Sbarro
51. Solid Rock Coffee Company
52. Subway
53. Super Taco
54. Taqueria El Rinconsito
55. Teriyaki Express
56. Tokyo House
57. Toyama Sushi
58. Yummy Deli

HOTELS

1. Best Western
2. Days Inn
3. Extended Stay America (2)
4. Holiday Inn Express
5. La Quinta Inn

FINANCIAL INSTITUTIONS

1. Bank of America (2)
2. Bank of Washington
3. Banner Bank
4. BECU
5. Chase
6. Key Bank
7. Union Bank
8. Washington Federal

SHOPPING

1. AT&T
2. Bed, Bath & Beyond
3. Best Buy
4. Burlington
5. Car Toys
6. Costco
7. Everett Mall: 60+ amenities
8. Famous Footwear
9. Goodwill
10. Half Price Books
11. Lovers
12. Macy's
13. Nextel
14. Old Navy
15. Party City
16. PetSmart
17. Sears
18. Target
19. TJ Maxx
20. Trader Joe's
21. Verizon Wireless

COMMUNITY, PARKS & REC

1. 24 Hour Fitness
2. Columbia Athletic Club
3. Everett Music Hall
4. Everett Public Library
5. Glacier Bowling Lanes
6. LA Fitness
7. Regal Cinemas
8. Silver Lake Park
9. Walter Hall Municipal Golf Course

CONTACT:

Derek Heed
Colliers International
T 425.453.3133
derek.heed@colliers.com



Larry Benaroya
T 425.440.6700
F 425.440.6730
larryb@benaroya.com

The Benaroya Company

Everett Park Place Professional Center - Area Transit



Everett Transit, Everett Station



Transfer to:

- Community Transit
- Skagit Transit
- Sounder Train
- Amtrak
- Greyhound

Everett Park Place Professional Center to Everett Station

- Everett Transit Route 7 

Everett Park Place Professional Center to Everett Mall

- Everett Transit Route 7 
- Everett Transit Route 12 

Everett Mall to South Everett Freeway Station

- Everett Transit Route 29 



Everett Transit, South Everett Freeway Station

Transfer to Sound Transit Routes:

- 510 - Seattle Express
- 512 - Seattle via Mill Creek, Alderwood, Mountlake Terrace
- 532 - Bellevue Express

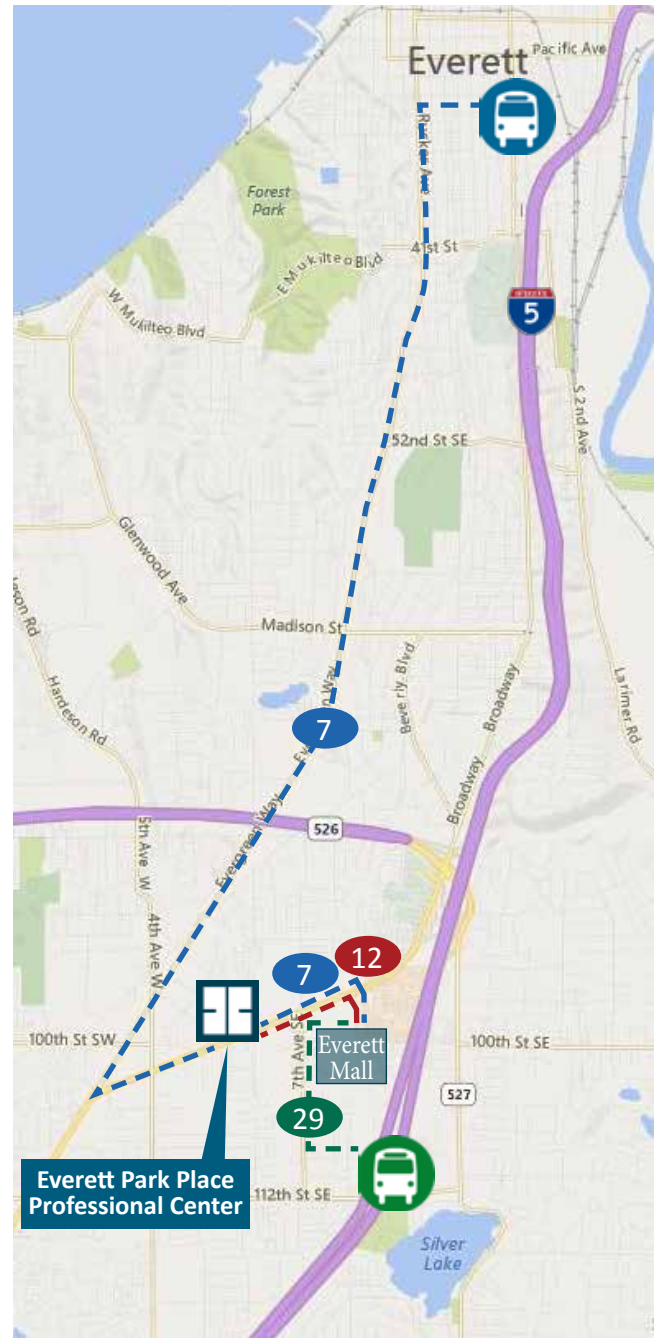

CONTACT:

Derek Heed
Colliers International
T 425.453.3133
derek.heed@colliers.com



Larry Benaroya
T 425.440.6700
F 425.440.6730
larryb@benaroya.com